

WINDOW TYPE 1 - 1800 x 1425mm.

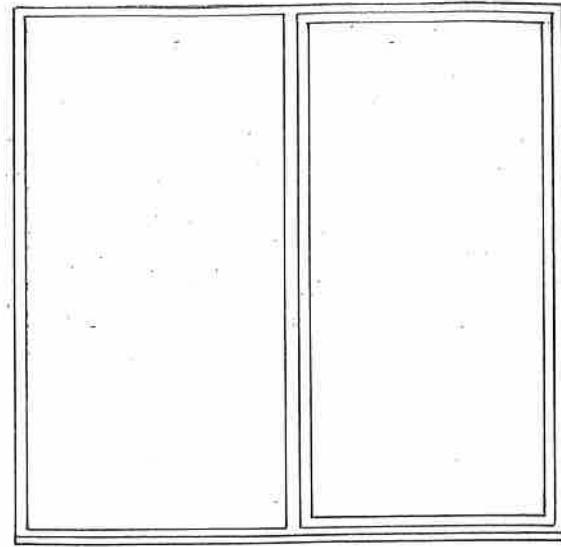

TYPE 5 - 1450 x 1425mm.

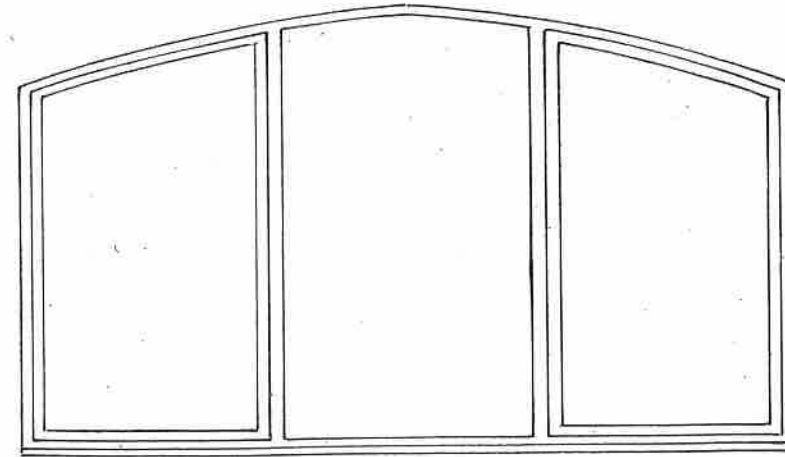

TYPE 8 - 2050 x 1200mm.

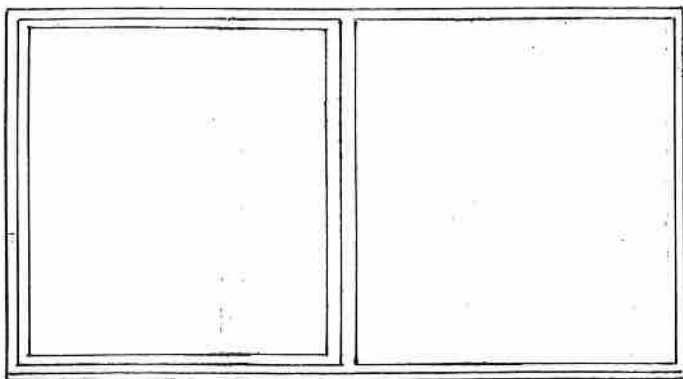

TYPE 2 - 1800 x 975mm.

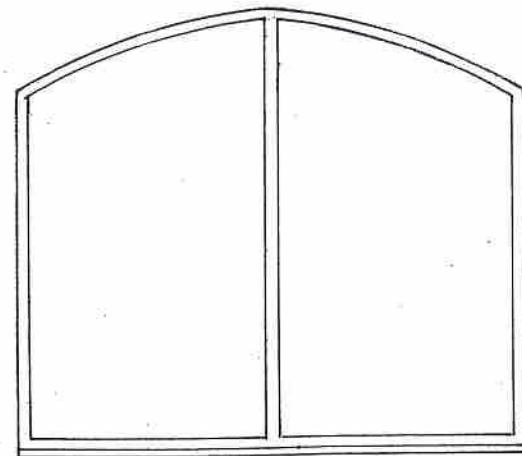

TYPE 6 - 1350 x 1200mm.

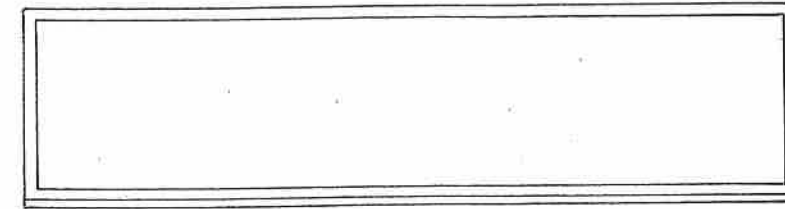

TYPE 9 - 2050 x 525mm.

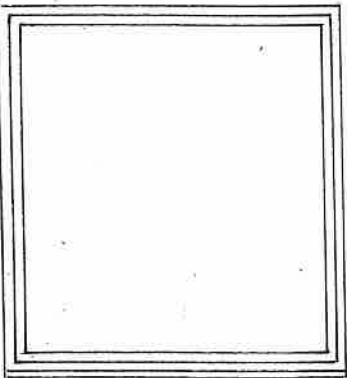

TYPE 3 - 900 x 975mm.

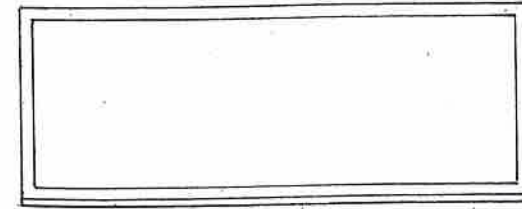

TYPE 7 - 1350 x 525mm.

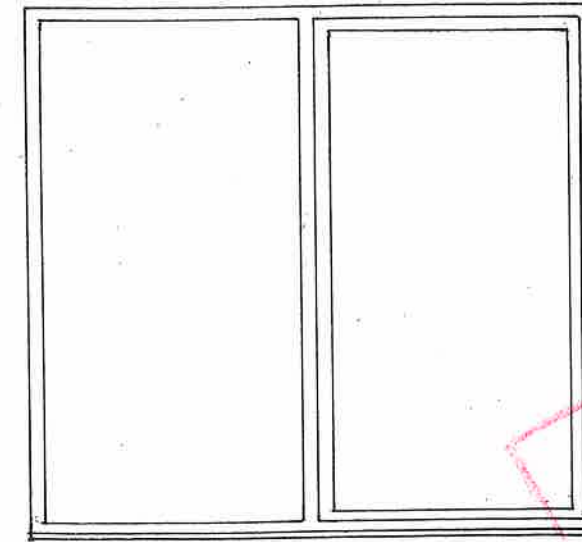

TYPE 10 - 1500 x 1425mm.

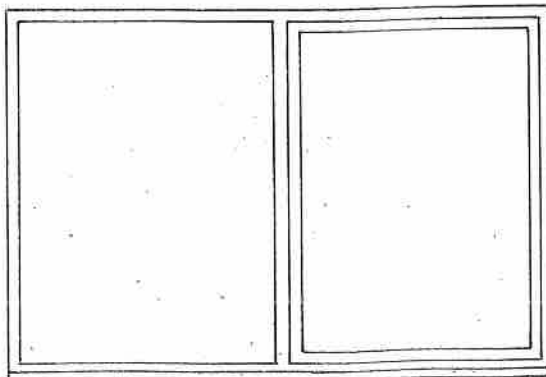

TYPE 4 - 1450 x 975mm.

WHITBURN HALL - WINDOW TYPES 1 REN.A-142 27/5/16
All windows to be slim-line upvc with Mahogany/Rosewood finish externally (generally with a white internal finish), with heavy duty hinges/hardware. Approximate dimensions to be verified on site to ensure that each window is an exact fit to existing opening sizes. Handing of opening sash may vary to match existing, but general window pattern to be maintained throughout the building. All Health and Safety, B.S., and Building Regulations requirements to be met in terms of safety glass, ease of cleaning, and means of escape.

SOUTH TYNESIDE MBC
31 MAY 2016
AREA PLANNING



Gary Craig
Architectural Services Ltd.

Gary Craig

10 Fulmar Walk
Whitburn
SR6 7BW

Tel: 0191 529 4964
Fax: 0191 529 4142
Mob: 07941 525602

Email: gcarchservices@tiscali.co.uk

APPROVED
PLAN

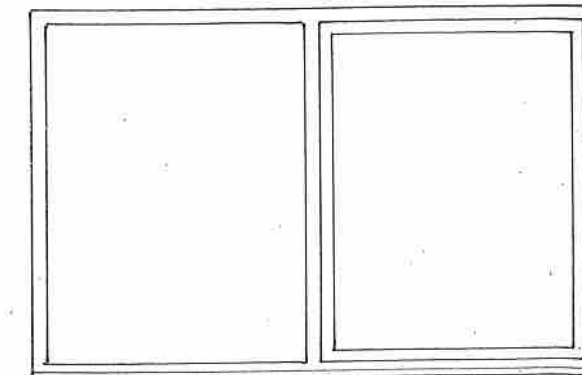

TYPE 11 - 1500 x 975mm.